

CT21 电流互感器(端子式) CT21 current transformer(terminal type)

产品特点 Features

- ◆ ABS/PC 外壳，耐高温，耐腐蚀；环氧树脂灌封，隔离性能好，抗冲击性强；体积小，外形美观，安装方便；线性好，精度高，线性范围宽，一致性好。用于进行电量采集及对电量的监测。
- ◆ ABS/PC case-resistance to high temperature and corrosion; Epoxy risen-perfect isolation and resistance to strong impact; Small in size and pleasant to eyes easy installation; Excellent linearity and isolation, high precision, wide in linearity range and overall consistency. Used for the electric quantity collection and power monitoring.

主要技术参数 Main parameters

型号 Model	额定输入/输出 Rated input/output	准确级 Accuracy	绝缘电阻 Insulation resistance	角差 Angle difference	负载电阻 Load resistance	隔离耐压 Isolated withstand voltage	穿线孔径 Threading aperture (mm)
CT21	5A/10mA(2T)	0.5	≥100Mohm	≤15'	≤20Ω	3kVac	Φ20
	50A/10mA	0.2		≤10'	≤20Ω		
	100A/20mA	0.2		≤10'	≤20Ω		
	150A/30mA	0.2		≤10'	≤20Ω		
	200A/40mA	0.2		≤10'	≤20Ω		
	50A/25mA	0.2		≤10'	≤30Ω		
	100A/50mA	0.2		≤10'	≤30Ω		
	50A/20mA	0.2		≤10'	≤30Ω		
	60A/24mA	0.2		≤10'	≤30Ω		
	100A/40mA	0.2		≤10'	≤30Ω		
	200A/80mA	0.2		≤10'	≤30Ω		
	100A/10mA	0.2		≤10'	≤20Ω		

产品规格 Specification (尺寸单位 Dimension unit: mm)

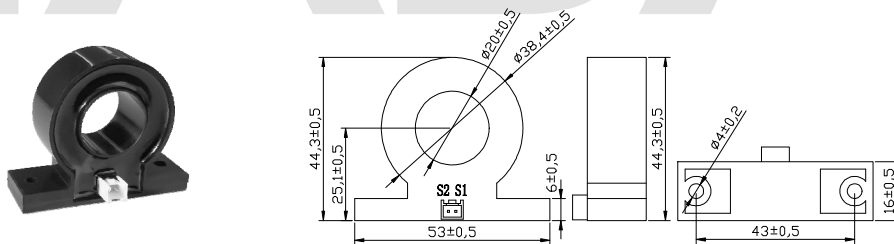

安装方式 Installation

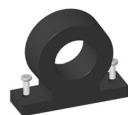

螺钉固定 fix with screw

说明 Note:

- 使用温度 Operating temperature: -40℃~50℃; 贮存温度 Storage temperature: -40℃~75℃;
- 相对湿度 Relative humidity: 10%~95%;
- 上表所列为常用规格，还可根据客户要求另行设计。The products are customized according to user's requirements.

注：以上图片仅供参考，产品以实物为准。

Note: The above picture is for reference only, the products are subject to the actual product, 版权所有，保留一切权利。内容如有改动，恕不另行通知。
Copyright, all rights reserved. Specification subject to change without prior notice.