

## CTF16T 电流互感器 CTF16T Current Transformer

### 产品特点 Features

- ◆ PA 外壳，耐高温，耐腐蚀，隔离性能好，抗冲击性强；体积小，外形美观，安装方便；线性好，精度高，线性范围宽，一致性好。适用于不断线、不拆线的条件下快速装卸，用于进行电量采集及对电量的监测。

PA case-resistance to high temperature and corrosion, risen-perfect isolation and resistance to strong impact; Small in size and pleasant to eyes easy installation; Excellent linearity and isolation, high precision, wide in linearity range and overall consistency. Applicable to rapid assemble and disassemble without broken or removing its connecting lead thread, used for the electric quantity collection and power monitoring.

### 主要技术参数 Main parameters

型号 Model	额定输入/输出 Rated input/output	准确级 Accuracy	绝缘电阻 Insulation resistance	角差 Angle difference	负载电阻 Load resistance	隔离耐压 Isolated withstand voltage	穿线孔径 Threading aperture
CTF16T-1k-100	100A/100mA	0.5	≥100Mohm	≤60'	≤10Ω	3.0kV	Φ16mm
CTF16T-2k5-50	50A/20mA	0.5	≥100Mohm	≤60'	≤30Ω	3.0kV	Φ16mm
CTF16T-2k5-100	100A/40mA						
CTF16T-5k-50	50A/10mA	0.5	≥100Mohm	≤60'	≤30Ω	3.0kV	Φ16mm
CTF16T-5k-100	100A/20mA						

### 产品规格 Specification (尺寸单位 Dimension unit: mm)

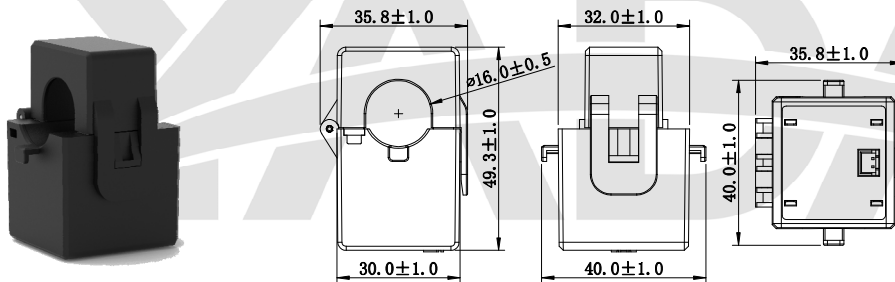

### 安装方式 Installation

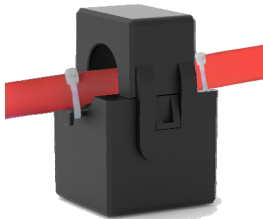

将一次电流线穿过互感器，用扎带将互感器固定在一次电流线上。

The primary current line is passed through the transformer, and the transformer is fixed on the primary current line with a tie band.

### 说明 Note:

- 使用温度 Operating temperature: -20℃~50℃； 贮存温度 Storage temperature: -40℃~75℃；
- 相对湿度 Relative humidity: 10%~95%RH；
- 上表所列为常用规格，还可根据客户要求另行设计。The products are customized according to user's requirements.

注：以上图片仅供参考，产品以实物为准，

**Note: The above pictures are for reference only, the products are subject to the actual product, 版权所有，保留一切权利。内容如有改动，恕不另行通知。**

**Copyright, all rights reserved. Specification subject to change without prior notice.**